



PowerPusher[®]
If It Rolls... We Can Move It.[™]

Super PowerPusher[™]

Battery-Powered Material Handling Equipment



The **Super PowerPusher**[™] has the push/pull capacity necessary to overcome extremely heavy or high rolling resistance loads, delivering the ability to maneuver virtually any industrial load. Featuring a low-maintenance design and heavy-duty construction for extreme durability, the Super PowerPusher is capable of mobilizing loads reaching up to 120,000 pounds and up to 250,000 pounds with dual motors. Plus, with its wide range of custom, modular attachments, this device is as flexible as the loads it transports.

NU-STAR, Inc.

powerpusher.com



PowerPusher[®]
If It Rolls... We Can Move It.[™]



PowerPusher[®]
If It Rolls... We Can Move It.[™]

Super PowerPusher[™] Battery-Powered Material Handling Equipment

FEATURES & BENEFITS

- 36-volt DC, 1500-watt motor provides 120,000 pound push/pull capacity
- Dual-Motor model available with 36-volt DC, 2 x 1500-watt motor provides 250,000 pound push/pull capacity
- Fully programmable control system with diagnostic features to adjust speed and acceleration/deceleration based on load and environment
- Solid rubber wheel drive with alternative tread patterns and materials specification for various floor applications
- Electrically powered with on-board charger for efficient, long-lasting operation
- Fingertip controls and compact construction deliver easy maneuverability
- Automatic braking for improved operator safety
- Ergonomic handles and hand guards for operator comfort and safety

OPTIONS

- Maintenance free batteries
- Strobe and audible motion beeper for safety and visibility on plant floor
- Remote control
- High traction and non-marking tires
- Stainless steel
- Fold up handles for smaller footprint
- Versatile standard and custom attachment options available - see website

MACHINE SPECIFICATIONS	
Motor Type:	Super PowerPusher: 36-volt DC -1500-watt Dual-Motor Super PowerPusher: 36-volt DC-2x 1500-watt
Drive Mechanism:	2 x chain & sprocket
Gear Box:	Single speed reduction gearbox, with differential
Controller:	Digital fully programmable, with fault diagnostic capability
Batteries:	3 x 90 Ah Dryfit, Gell Type. Sealed & maintenance free
Battery Charger:	On-Board, 3 stage, 3 x 15 Amp output 110v or 240v
Push/Pull Capacity:	Super PowerPusher: Up to 120,000 lbs. (subject to rolling resistance) Dual-Motor Super PowerPusher: Up to 250,000 lbs. (subject to rolling resistance)

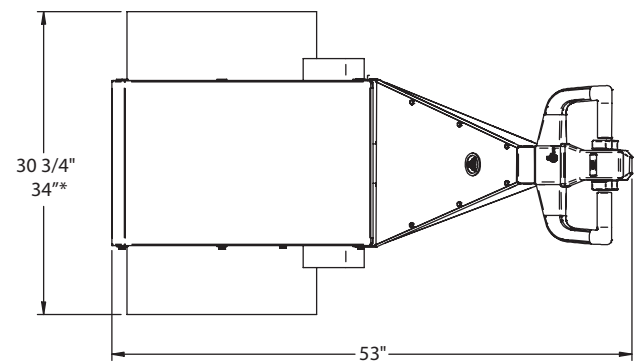
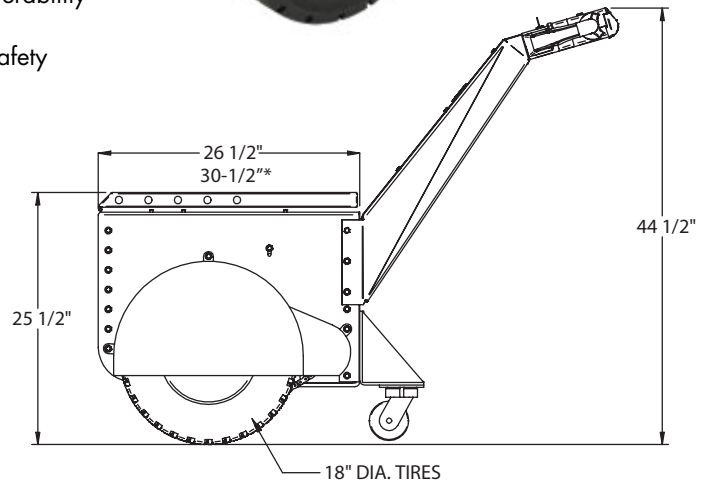

*For Dual-Motor Super PowerPusher 57**



1425 Stagecoach Road, Shakopee, MN 55379
Phone: 800.800.9274 or 952.445.8295

powerpusher.com



PowerPusher[®]
If It Rolls... We Can Move It.[™]